

CANAVAC 120V CENTRAL VACUUM WIRING DIAGRAM WITH MOTOR CONTROL BOARD

⚠ WARNING

UNPLUG THE POWER CORD FROM THE RECEPTACLE BEFORE SERVICING!

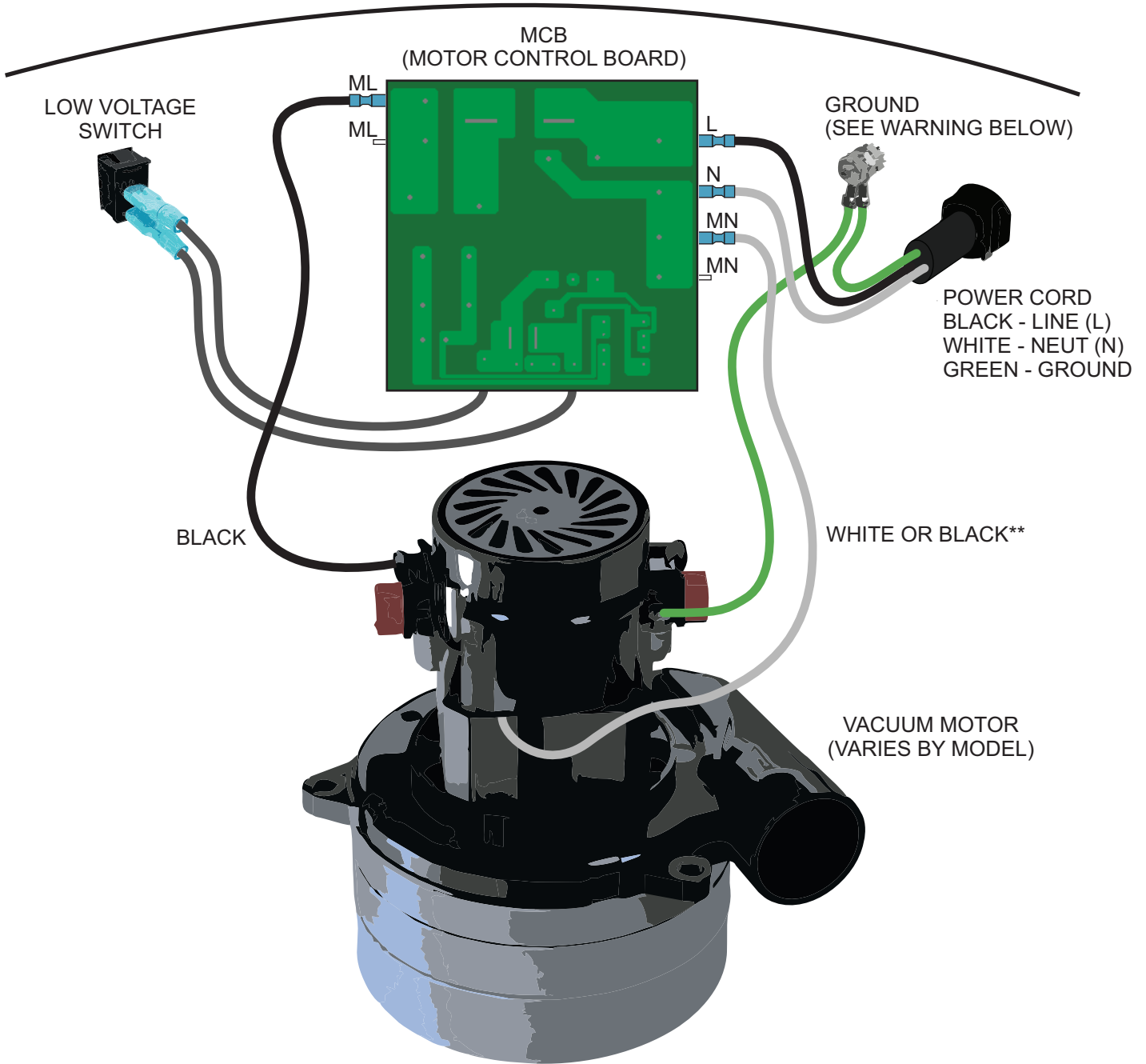

** SOME MOTOR MODELS HAVE TWO BLACK WIRES.
CONNECT EITHER BLACK WIRE TO THE MN TERMINAL
AND THE OTHER BLACK WIRE TO ML.

NOT ALL MOTORS HAVE A GROUND CONNECTION.
MOTORS WITH A GROUND WIRE MUST BE GROUNDED AS SHOWN.

⚠ WARNING



Electrical Shock Hazard
All ring terminals must be secured with a nut & lock-washer.
Power cord ground wire must be connected directly to the chassis.

Failure to follow these instructions can result in death or electric shock.